

# DRUMORE CROSSINGS

Drumore Township, PA

G.L.A. 322,169 S.F.

**WOLFSON GROUP, INC.**

Meetinghouse Business Center  
120 W. Germantown Pike  
Suite 120  
Plymouth Meeting, PA 19462  
(610) 277-8899  
Manager and Exclusive Agent of Owner

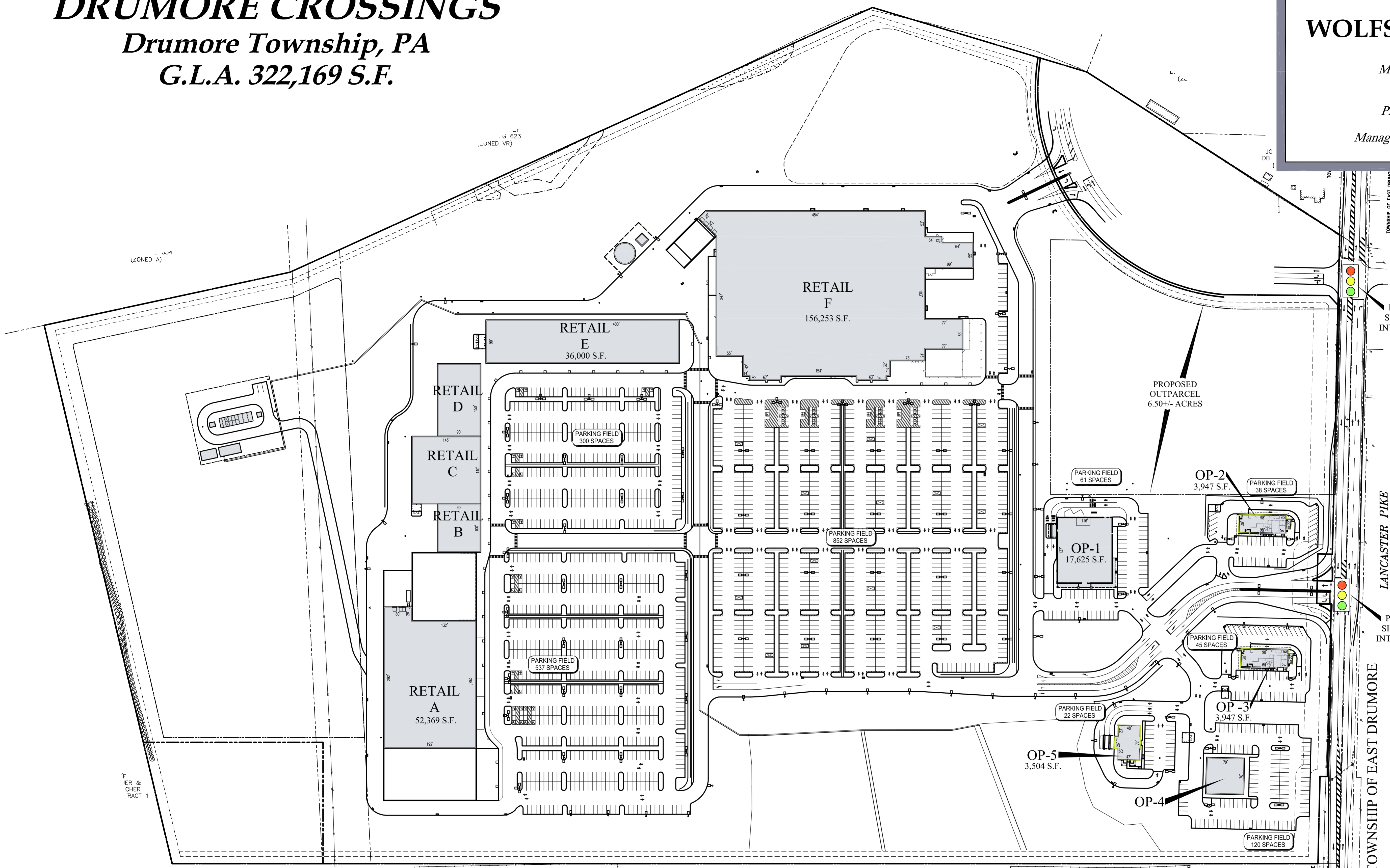

PROPOSED SIGNALIZED INTERSECTION

PROPOSED OUTPARCEL 6.50 +/- ACRES

PROPOSED SIGNALIZED INTERSECTION

LANCASTER PIKE

TOWNSHIP OF EAST DRUMORE

THIS PLAN IS FOR INFORMATIONAL PURPOSES ONLY. LANDLORD HEREBY RESERVES THE RIGHT, AT ANY TIME AND FROM TIME TO TIME, TO ALTER OR OTHERWISE MODIFY THE LOCATIONS AND/OR EXISTENCE AND/OR DIMENSIONS OF ALL BUILDINGS, PARKING AREAS, SERVICE DRIVES, ENTRANCES, EXITS, AND OTHER FACILITIES SHOWN ON THE PLAN, TO PLACE IN COMMON AREAS OF THE SHOPPING CENTER LANDSCAPING, DECORATIVE ITEMS AND STRUCTURES AND AREAS FOR RETAIL SALES AND PROMOTIONAL ACTIVITIES, AND TO CONSTRUCT, LEASE, OPERATE AND MAINTAIN IN THE AREA SHOWN ON THIS PLAN AND ON CONTIGUOUS LAND, AS PART OF THE SHOPPING CENTER, BUILDINGS, STRUCTURES AND OTHER FACILITIES NOT SHOWN ON THIS PLAN, PROVIDED HOWEVER, THAT LANDLORD DOES NOT VIOLATE ANY RIGHTS EXPRESSLY RESERVED TO TENANT IN THIS LEASE.

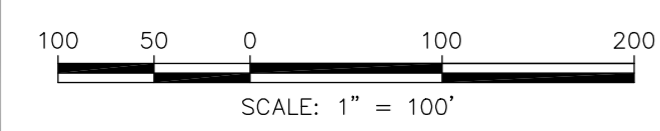

<p><b>BOHLER ENGINEERING, INC.</b> 1600 MANOR DRIVE, SUITE 200 CHALFONT, PA 18914 215.383.8300 215.383.8130 Fax www.bohlereng.com</p>	
<p>CIVIL &amp; CONSULTING ENGINEERS ■ SURVEYORS ■ TRAFFIC CONSULTANTS ■ ENVIRONMENTAL &amp; GEOTECHNICAL ENGINEERS OTHER OFFICE LOCATIONS: ■ WATCHUNG, NJ ■ MELVILLE, NY ■ STERLING, VA ■ SOUTHBORO, MA ■ TOWSON, MD ■ ALBANY, NY</p>	
<p>PROJECT: <b>WOLFSON GROUP, INC. DRUMORE CROSSINGS</b> PA ROUTE 272 DRUMORE TOWNSHIP, LANCASTER COUNTY, COMMONWEALTH OF PENNSYLVANIA</p>	
<p><b>B.R. ZAPPALA</b></p>	
<p>PROFESSIONAL ENGINEER PENNSYLVANIA LICENSE No. 044843-CE NEW JERSEY LICENSE No. GE38442 MARYLAND LICENSE No. 2091738 DELAWARE LICENSE No. 107738 VIRGINIA LICENSE No. 0302280</p>	
<p>CALL BEFORE YOU DIG! PENNSYLVANIA ACT 287 OF 1974 (AS AMENDED BY ACT 187 OF 1996) REQUIRES 3 WORKING DAYS NOTICE FOR CONSTRUCTION PHASE AND 5 WORKING DAYS IN DESIGN STAGE - STOP CALL!</p>	
<p>PENNSYLVANIA ONE CALL SYSTEM, INC. 1-800 242-1776</p>	
<p>DATE: 3/2/2007 DRAWN: SPM CHECKED: BRZ</p>	<p>SCALE: (H): 1"=100' (V): 1"=10' PROJECT No.: P02-1029 CAD L.D. #: P02-1029.P 2007-03-02</p>
<p>SHEET NO.: 1 OF 1</p>	<p>CONSTRUCTION CHECK DATE</p>